

# DECKfon<sup>®</sup> 17T, 26T, 30T

Acoustic floor board for refurb and conversion timber floors

DECKfon acoustic overlay treatments are designed for conversion projects where the joist are covered with a timber decking and the ceiling is to be replaced. When installed as part of an acoustic system they are fully compliant with Part E of the Building Regulations.



**KEY BENEFITS**

- ⬡ Excellent soundproofing properties
- ⬡ Quick and easy to install
- ⬡ Three thickness' available 17, 26 & 30mm
- ⬡ Tongue and groove edge detail
- ⬡ Noisy neighbour solution

**PHYSICAL PROPERTIES**

Properties	Unit	DECKfon 17T	DECKfon 26T	DECKfon 30T
Resilient layer composition	-	Open-cell, low resonance, recycled, flexible polyurethane (Grade A2)		
Type and thickness of facing / batten	-	9mm MR MDF	18mm P5 chipboard	22mm P5 chipboard
Resilient layer thickness	mm	8	8	8
Overall thickness	mm	17	26	30
Board size / roll size / batten length	m	0.6 x 2.40	0.6 x 2.40	0.6 x 2.40
Weight	kg/m <sup>2</sup>	7.45	13.40	16.20
	kg/sheet	10.74	19.29	23.32

**ADDITIONAL INFO**

**PCT Treatment**

**TIMBER**

**Recycled Material**

Installation video available on **CELLECTA App**

**RESOURCES**



For full technical and application information please consult our full acoustic insulation brochures. To speak to someone regarding your requirements please call **08456 71-71-74** or email **CELLECTA** on [technical@cellecta.co.uk](mailto:technical@cellecta.co.uk)



Refurbishment. Existing timber joists  
Acoustic treatment laid on sub floor. Metal frame secondary ceiling

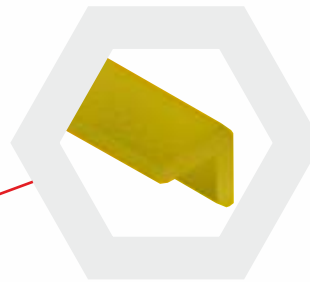
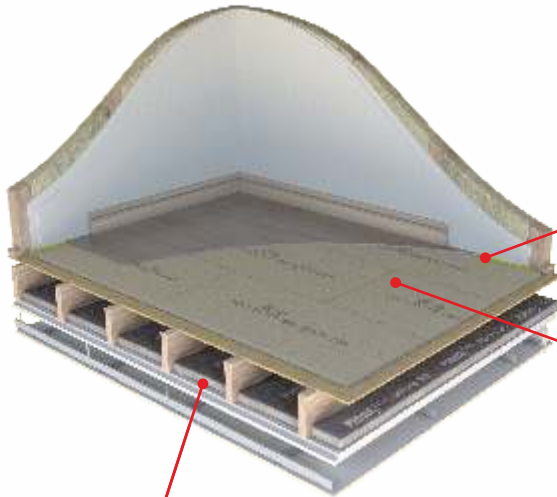

### YELOfon® FS30

Lightweight, flexible extruded polyethylene strips. When installed around the floor perimeter they will eliminate acoustic flanking with the wall and the treatments



DECKfon® 17T Acoustic overlay board

DECKfon® 26T Acoustic overlay board

DECKfon® 30T Acoustic overlay board

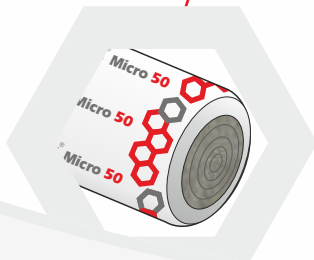

### FIBREfon® Micro 50

Sound absorbing quilt made from a unique polyester fibre which provides very high sound absorption properties. Thanks to their unique composition they are also super soft and itch-free unlike rock and mineral wools, making them easy to handle on site

## INSTALLATION DETAILS

For the full installation guide, visit [www.cellecta.co.uk](http://www.cellecta.co.uk) and view the online video or download the Cellecta app to your smart phone.

- ⊞ Remove the existing timber sub deck
- ⊞ Install FIBREfon® Micro 50 between the joists
- ⊞ Re-install or replace the timber sub-deck
- ⊞ Install DECKfon® 17T/26T/30T on the sub deck
- ⊞ Install YELOfon® FS30 around floor perimeter to prevent acoustic flanking

## TECHNICAL ADVICE & SUPPORT

CELLECTA manufacture a range of high performance thermal and acoustic insulation products, supported by a technical advice line staffed by experienced consultants who can provide a number of useful services:

- ⊞ Technical and installation advice
- ⊞ Give advice on the most suitable product to use
- ⊞ Supply detailed fixing instructions
- ⊞ Arrange site surveys
- ⊞ Design specifications

## TYPICAL ACOUSTIC PERFORMANCE

### DECKfon® 26T

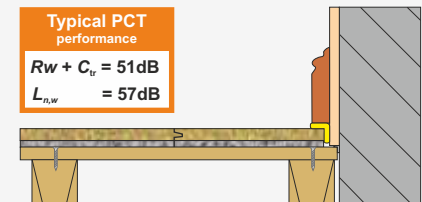

### DECKfon® 17T

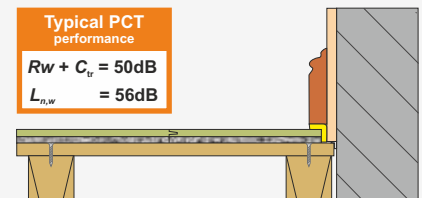

### DECKfon® 30T

