

IsosonicTM Timberfloor

FLOOR SOUND INSULATION SYSTEM FOR NEWBUILD AND REFURBISHMENT

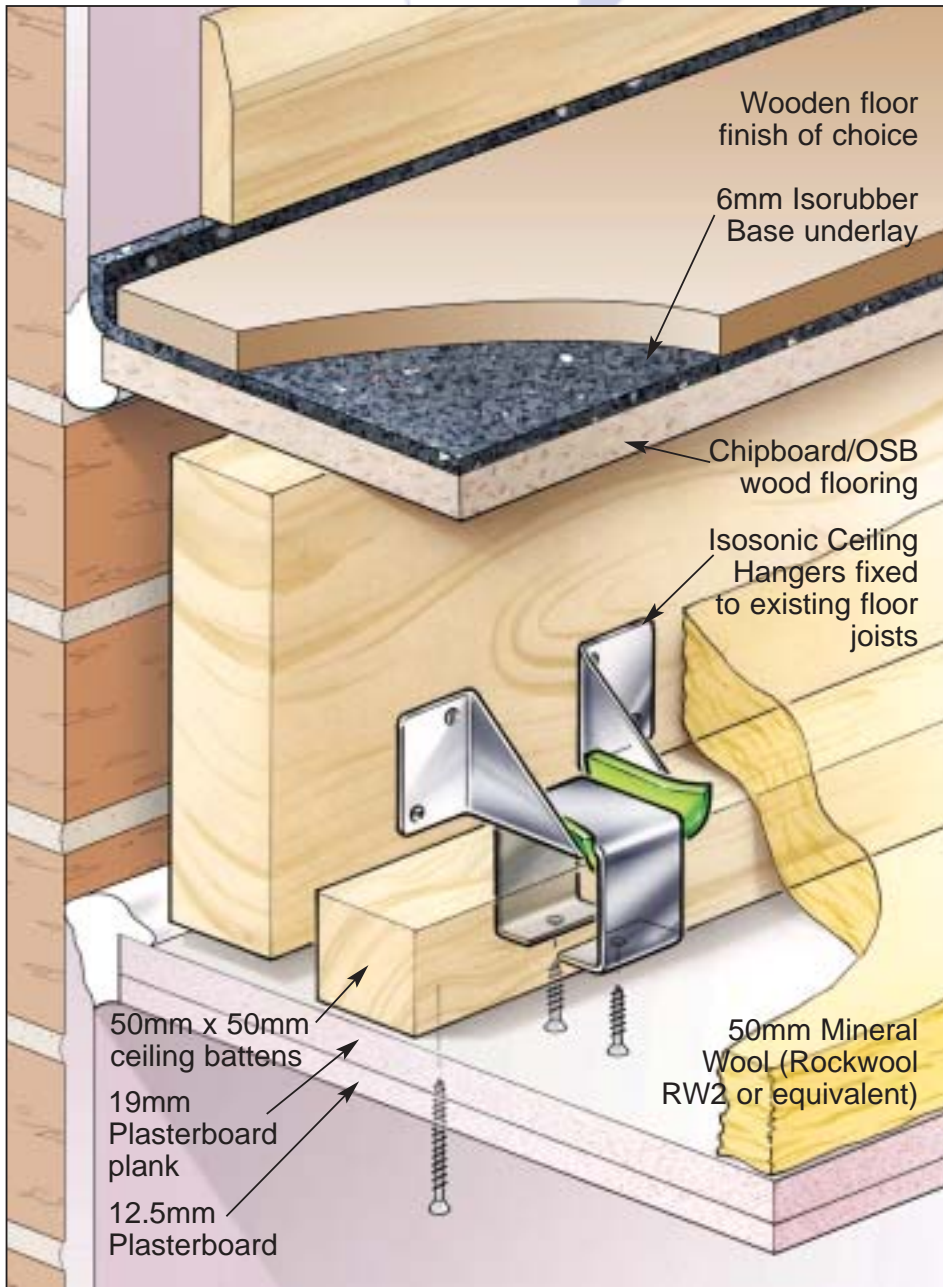

The ISOSONIC TIMBERFLOOR provides safeguards against failure with 'precompletion testing'.

- ✓ Site tested performance far in excess of test requirements
- ✓ Simple installation reducing workmanship errors
- ✓ Integral flanking sound insulation, eliminating difficult edge strips
- ✓ Detailed installation for floor, ceiling, downlighters and partitions- aiding the builder and specifier

SITE TEST PERFORMANCE COMPARABLE TO R.D. STANDARDS

- **A high performance, low cost and simple to install system.**
- **Provides a unique integral barrier to flanking sound transmission which is the predominant cause of test failures.**
- **ISORUBBER BASE is suitable for the direct application of timber and laminate floors without a board platform.**

CEILING CONSTRUCTION OPTIONS

The IsoSonic Ceiling Hanger Systems facilitate the easy levelling of ceilings to 'old' timber floors.

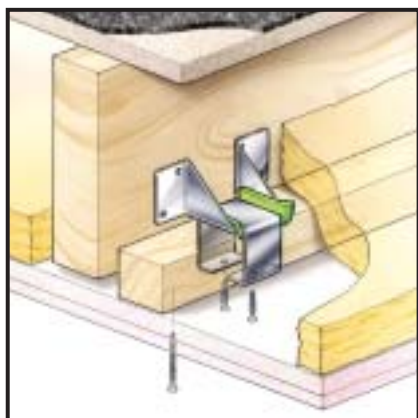

Ceiling Hanger type A

FOR MINIMAL LOSS IN CEILING HEIGHT

5mm lowering of ceiling.

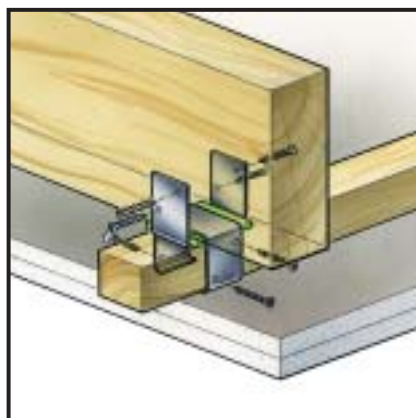

Ceiling Hanger type B

FOR ADJUSTABLE CEILING HEIGHT

Hangers can be made to suit the exact ceiling level requirements.

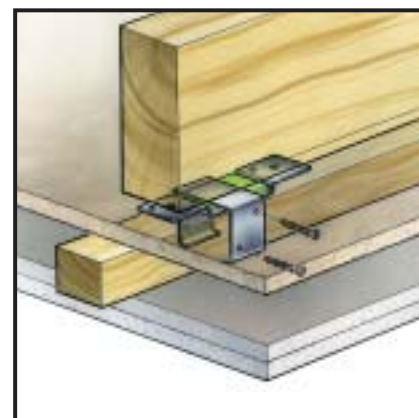

Ceiling Hanger type D

FOR RETAINED CEILINGS

Allows the new sound insulating fire protective ceiling to be installed without the removal of the existing ceiling.

ISOSONIC CEILING HANGERS

a) The number of ceiling hangers required per square metre of floor will depend on the geometry of the room. Regular rectangular rooms require approximately 2.5 hangers per square metre of floor area.

b) Spacing of the ceiling hangers should not exceed 800mm.

PACKAGING

6mm Isorubber Base-

Rolls: 1.25m x 10m = 12.5m²
Weight per roll: 45kg

IsoSonic Ceiling Hangers-

Boxes: 100 pieces per box.

FITTING INSTRUCTIONS

For full fitting instructions refer to the "IsoSonic Timber Floor Installation Guide", obtainable from the Thermal Economics technical department or website.

N.B. The IsoSonic Timber Floor is **not** an official R.D. but has been tested to similar standards.

Approved Document E July 2003 (P.C.T.) Requirements

Robust Detail test requirements

Examples of ISOSONIC TIMBERFLOOR site test results

SOUND INSULATION PERFORMANCE DATA

Dn tw + Ctr Airbourne Sound		Ln tw Impact Sound
Newbuild	45 dB minimum	62 dB maximum
Refurbishment	43 dB minimum	
Average of 30 tests	50 dB minimum	57 dB maximum
Any one single test	47 dB minimum	60 dB maximum
18mm Chipboard over Isorubber Base	50	56
Laminate floor over 18mm chipboard over Isorubber Base	51	54

- The above testing was carried out by an independent ANC Accredited Acoustic Consultant.
- The weight of the surface material is likely to influence the sound insulation performance.
- Further advice, information and the installation manual are available from our technical department.



Thermal Economics Ltd Thermal House 8 Cardiff Road Luton Bedfordshire LU1 1PP

Tel:01582 450814 Fax:01582 429305 E-mail:info@thermal-economics.co.uk Web:www.thermal-economics.co.uk

©Thermal Economics Ltd. Issue 7 Sep 2004