

Trim 'Exclusive'

Acoustic Floor Systems

Trim Defender 28

High Performance Acoustic Floor System



Trim Defender 28 can be laid directly onto a concrete floor or on top of an existing timber floor construction in a broken bond pattern with all joints glued and perimeters sealed using 30mm x 10mm Perimeter isolation tape.

Features & Benefits

- Supports Floor Loadings defined in BS: 6399-1: 1996
- Superior Performance - the recycled foam used has excellent impact Improvement characteristics and superior stability within a single layer.
- Foam fire tested to BS4790
- Quality Assured - Trim Acoustics products meet all current standards.
- Installation conforms to Document E

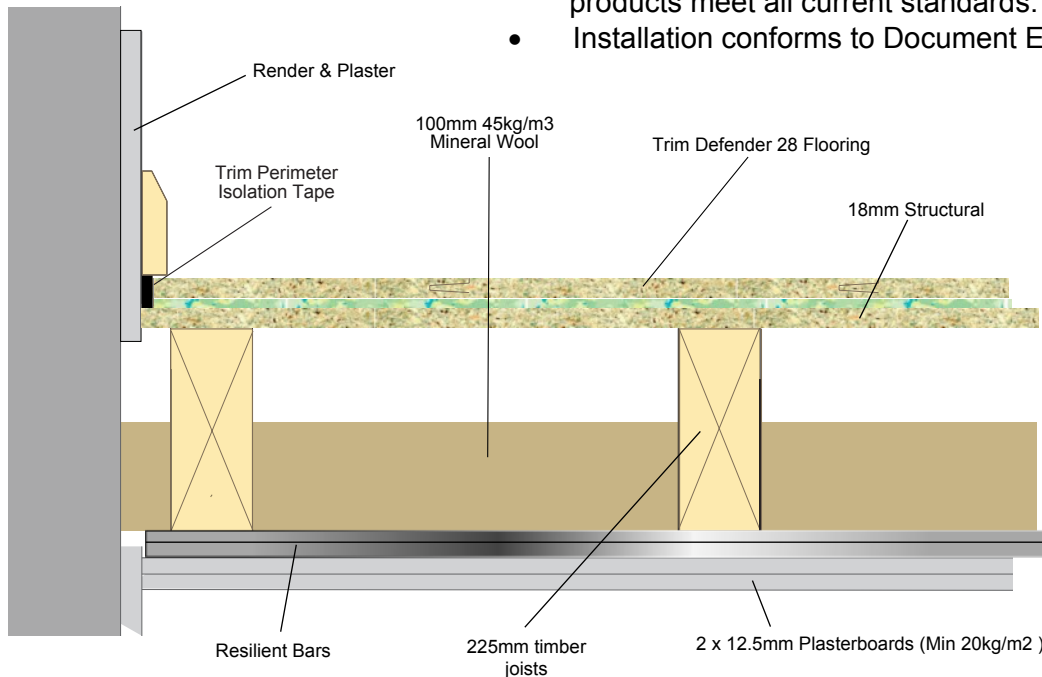

Flanking Transmission

The acoustic performance of a floor can be compromised by the passage of sound through walls and ducts, which adjoin or penetrate a floor, a phenomenon known as flanking transmission. To reduce flanking transmission the acoustic flooring must be isolated from walls and other structural elements. Trim Acoustics Isolation Strip is a flexible polyethylene strip designed to form a seal between the flooring and the wall.

Performance

Treated timber floor with resilient bar ceiling	$D_{nT,w} + C_{tr}$	$L_{nT,w}$
	49dB	49dB

Performance figures based on Defender 28 laid over 18mm chipboard with a ceiling construction of: 45kg/m³ insulation between joist & 2 x 12.5mm Plasterboards on resilient bars

Treated Concrete Floor	ΔL_w
	19dB

Performance figures based Defender 28 laid over a 365kg/m² concrete floor with a plaster skim.

System Components

Overall Dimensions	2400mm x 600mm x 28mm thick
18mm P5 moisture resistant chipboard	
Resilient layer composition	10mm Recycled Acoustic Chip Foam With anti crumb encapsulating layer.

For concrete floor applications Trim Defender 28 can be laid directly on the concrete or used in conjunction with Trim Acoustic Cradle System, extending the flexibility of this board were impact performance is required with varying floor heights.

Contact your local branch for more details